

NCH SERIES

(Ø200mm TO 350mm) Tie-Rod Design

Features

- Heavy Duty Pneumatic Cylinder
- Rugged Construction with Cast Iron End Covers
- Single/ Double Acting Type
- Adjustable cushioning at both Ends for better control.
- Self-Lubricating Design.



Material of construction

End Covers	C.I. Casting
Barrel	Mild Steel/ Aluminium
Piston Rod	SS410/ SS304/ SS316
Piston	C.I. Casting
Piston Rod Guide	Self-Lubricating High Polymer
Piston Guide	High Polymer
Piston Rod Seal	NBR(70 – 75 SH)/ Viton/ EPDM/ Silicon
Cover Seals	NBR (70 - 75 SH)

NCH SERIES

(Ø200mm TO 350mm) Tie-Rod Design

Technical Specifications

Cylinder Bore Ø (mm)	200	250	300	350
Stroke Length (mm)	Customized (15mm to 2800mm)			
Operating Pressure (bar)	1 - 10 bar.			
Operating Temperature (° C.)	Standard 0 - 70° C. Special Seals -5 - 150° C.			
Operating Medium	Filtered Compressed Air			
Cushioning	Elastic Cushioning Pads at both ends. Pneumatic cushioning, adjustable at both ends			
Position Sensing	Via Proximity Switch			
Tolerance	Stroke Length 0-500mm - +/- 2mm Stroke Length 500-2800mm - +/- 4mm			

Force for Double Acting Cylinder

Double Acting Cylinder								
Ø Bore	Ø Piston Rod		Force (N)					
			3 bar	4 bar	5 bar	6 bar	7 bar	8 bar
200	40	Advancing	9420	12560	15700	18840	21980	25120
		Retracting	9040	12050	15061	18091	21104	24120
250	40	Advancing	14719	19625	24531	29437	34343	39250
		Retracting	14340	19125	23902	28702	33475	38265
300	40	Advancing	21195	28260	35325	42390	49455	56520
		Retracting	20831	27775	34705	41655	48606	55541
350	40	Advancing	28849	38465	48081	57697	67314	76930
		Retracting	28490	37978	48475	56980	66476	75873

Note: Consult Factory for Force Calculations of single acting cylinder.

NCH SERIES

(Ø200mm TO 350mm) Tie-Rod Design

Standard Dimensions

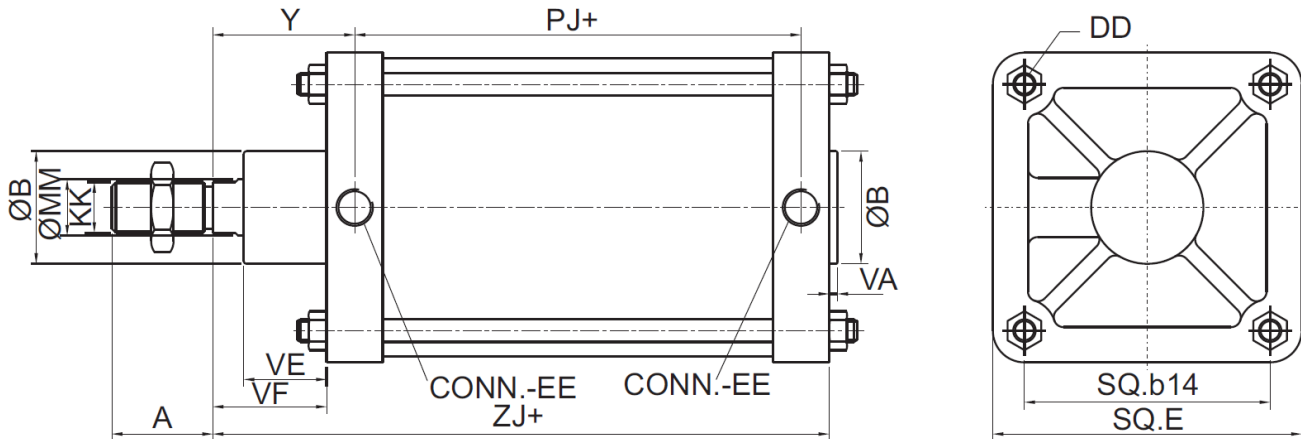

Bore Ø (mm)	A	B Ø	DD	E	EE	KK	MM	PJ	b14	VA	VE	WF	Y	ZJ	SLW
200	72	80	M16	220	G 3/4"	M36X2	40	118	175	6	59	81	101	239	36
250	72	80	M20	290	G 3/4"	M36X2	40	128	226	6	59	81	101	250	36
300	72	90	M24	330	G 3/4"	M36X2	40	139	255	6	59	81	108	272	36
350	72	90	M24	380	G 3/4"	M36X2	40	148	300	6	59	81	108	308	36